

MARINERS PARK PROJECT

Background & Purpose



PRINCE RUPERT

DISCOVER OUR NATURE

WHY MARINERS PARK

- Iconic central location overlooking the Prince Rupert Harbour in the centre of Prince Rupert
- Natural connection between Cow Bay and the rest of Prince Rupert's downtown, widening the circle of visitor impact from Cow Bay
- Scale and size of the park allows for broad impact on both locals and visitors
- Response to visitor feedback on the need for sheltered outdoor spaces in Prince Rupert's downtown
- Timing in relation to other Infrastructure Projects
- Opportunity for placement of art & culture installations that will be accessible to all
- Connection to Prince Rupert 2030 Vision & City of Prince Rupert's current park planning process



PROJECT PARAMETERS

DESIGN SCHEDULE

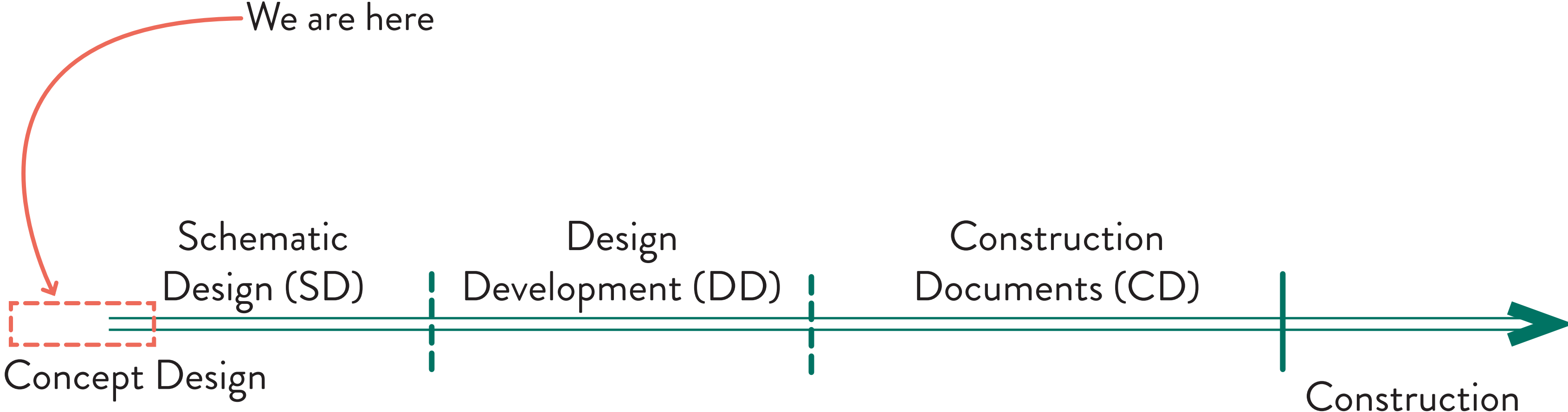

PROJECT BOUNDARY & EXISTING ASSETS

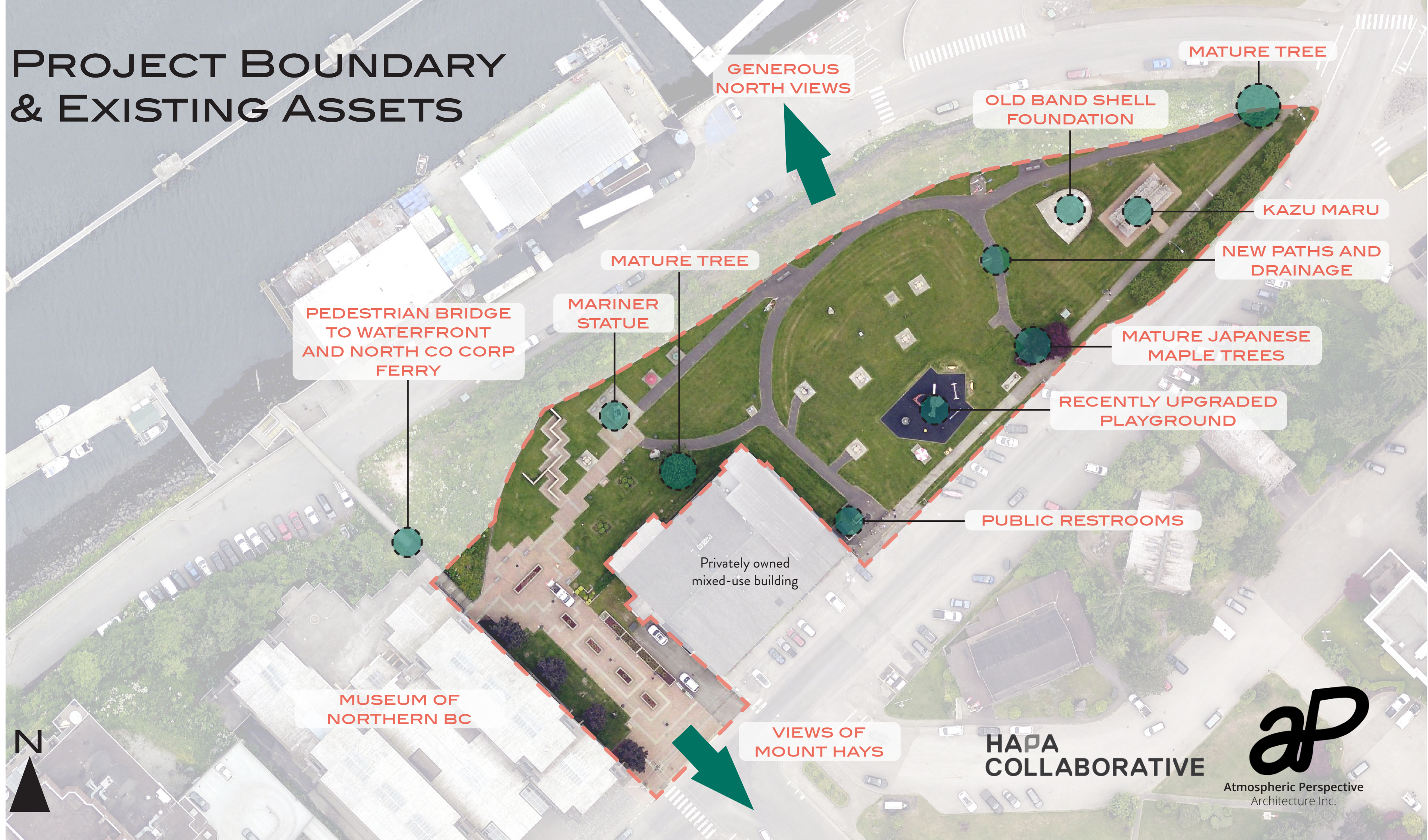

GENEREROUS NORTH VIEWS

MATURE TREE

OLD BAND SHELL FOUNDATION

KAZU MARU

NEW PATHS AND DRAINAGE

MATURE TREE

PEDESTRIAN BRIDGE TO WATERFRONT AND NORTH CO CORP FERRY

MARINER STATUE

MATURE JAPANESE MAPLE TREES

RECENTLY UPGRADED PLAYGROUND

PUBLIC RESTROOMS

Privately owned mixed-use building

MUSEUM OF NORTHERN BC

VIEWS OF MOUNT HAYS

HAPA COLLABORATIVE



Atmospheric Perspective Architecture Inc.



EXISTING MEMORIALS



KAZU MARU MEMORIAL

SIGNAL FLAG POLE

SCANDINAVIAN MEMORIAL

MEMORIAL TREE

LIGHTHOUSE MEMORIAL

MARINER STATUE

MEMORIAL WALL

CONSTRUCTION WORKERS MEMORIAL



HAPA COLLABORATIVE



Atmospheric Perspective Architecture Inc.

OPPORTUNITIES FOR IMPROVEMENT



STAIRWAY
REDUCING
ACCESSIBILITY

DETERIORATING
MEMORIAL
WALL

SCATTERED AND
INACCESSIBLE PICNIC
TABLES

BANDSHELL
WITH POOR
ACOUSTICS

POOLING RAIN
WATER

CHAIN LINK
FENCE

LACK OF ACCESSIBLE
SEATING AT PLAYGROUND

DETERIORATING
ACCESS STAIRS

DETERIORATING RUBBER
PLAY SURFACE

OPEN ACCESS
TO UNDER
UTILIZED
COURTYARD

LONELY UMBRELLA
TABLE

PUBLIC RESTROOMS

PARKING AREA
& DUMPSTER

UN EVEN
PAVERS &
OUT OF DATE
LIGHTING



**HAPA
COLLABORATIVE**



Atmospheric Perspective
Architecture Inc.

PROJECT GOALS

STRENGTHEN VISITOR
EXPERIENCE BY
SUPPORTING THRIVING
COMMUNITY PLACES

Community Economic
Opportunity

Support Community
Development
The People Are The
Place

Indigenous Reconciliation
& Celebration

All Weather
Events Space

HAPA
COLLABORATIVE

ap

Atmospheric Perspective
Architecture Inc.

GUIDING PRINCIPLES



Heart of Civic Life



Sustainability



Connection to Tsimshian Culture



Connection to Coastal Life



Local Character

HAPA
COLLABORATIVE



Atmospheric Perspective
Architecture Inc.

INITIAL CONCEPT IDEAS

APPROACH

HAPA
COLLABORATIVE



Atmospheric Perspective
Architecture Inc.

CONTEMPLATE

GATEWAY

EVENTS

PLAY

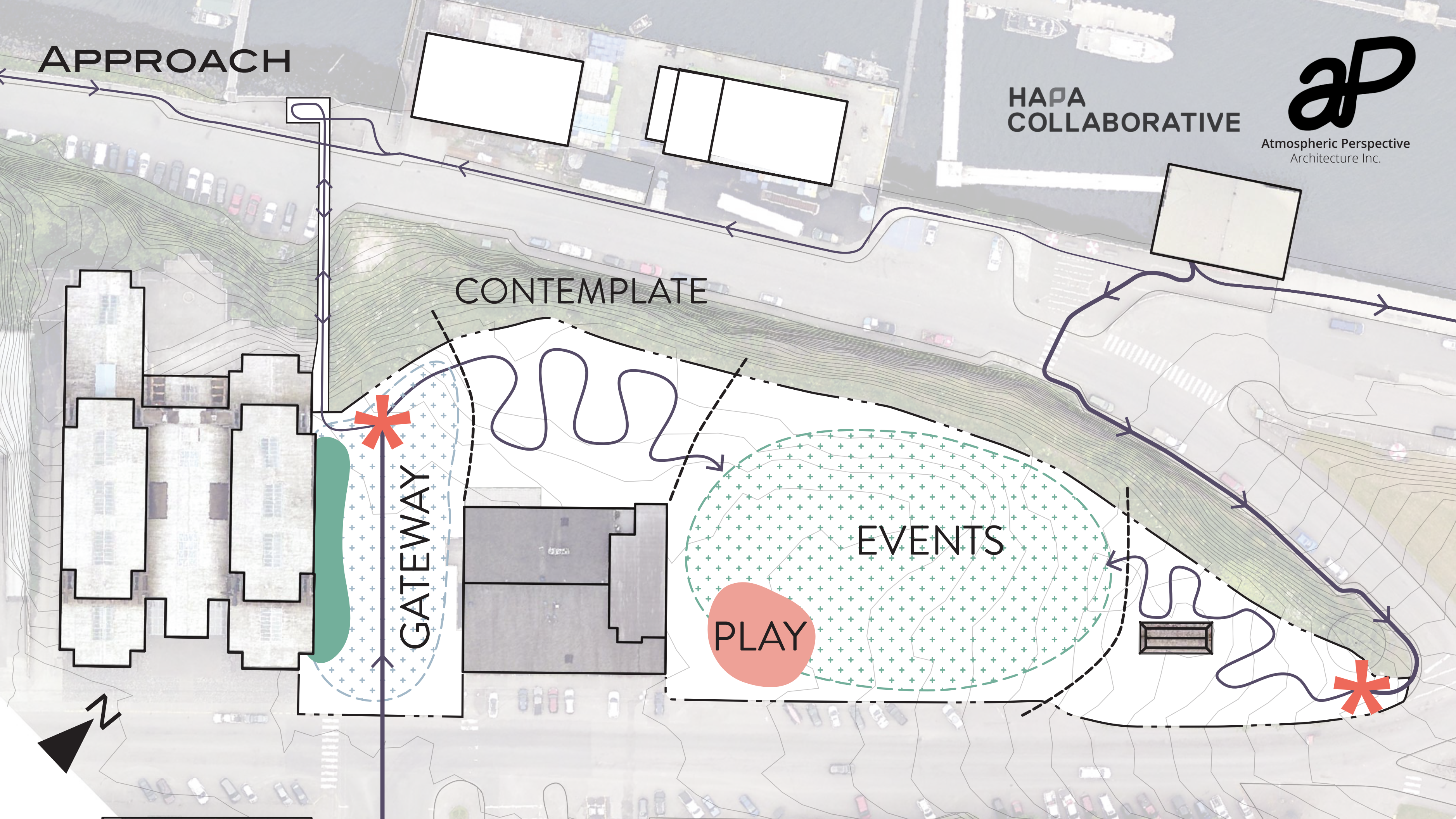

CONCEPT IDEAS

MEMORIALS RELOCATED TO THE MEMORIAL GARDEN

THE LOOKOUT

MEMORIAL GARDEN

THE GROVE

MARINER STATUE

THE PAVILION

FOREST GARDEN

THE COMMONS

THE MEWS

KAZU MARU



HAPA
COLLABORATIVE



Atmospheric Perspective
Architecture Inc.

PLACEMAKING LANDMARKS

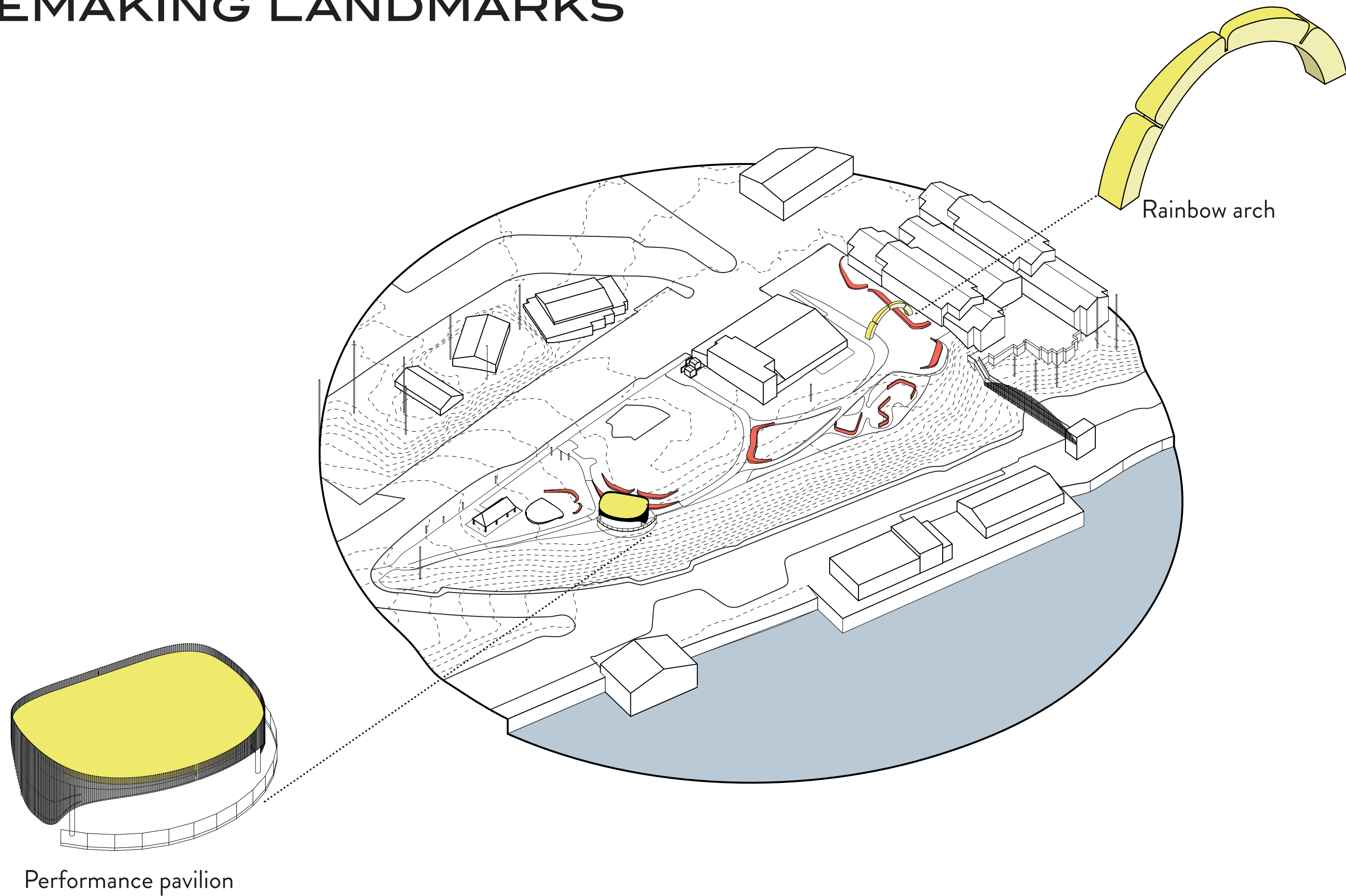

THE MEWS & THE GROVE

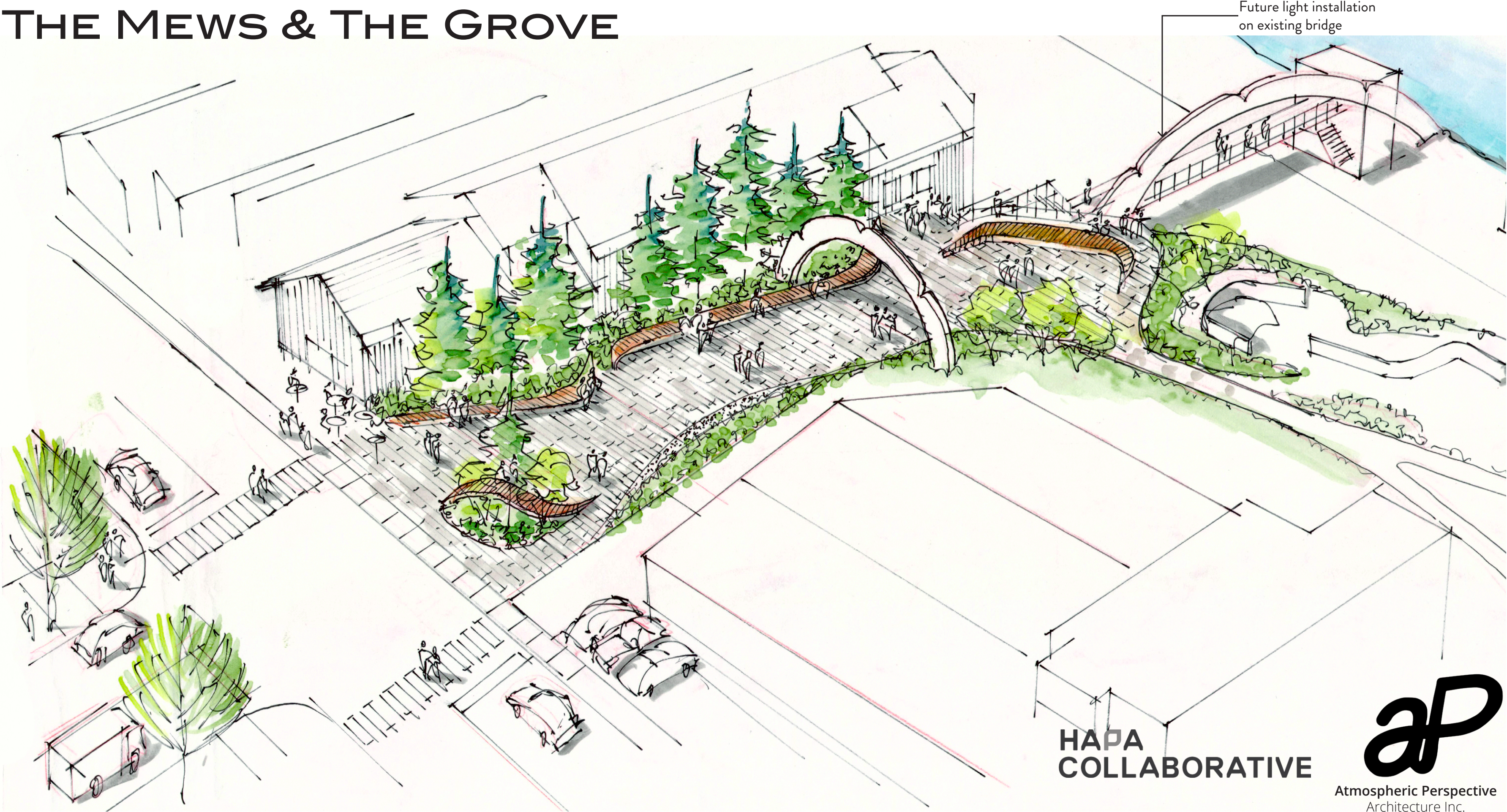

Future light installation
on existing bridge

**HAPA
COLLABORATIVE**



Atmospheric Perspective
Architecture Inc.

PERFORMANCE PAVILION

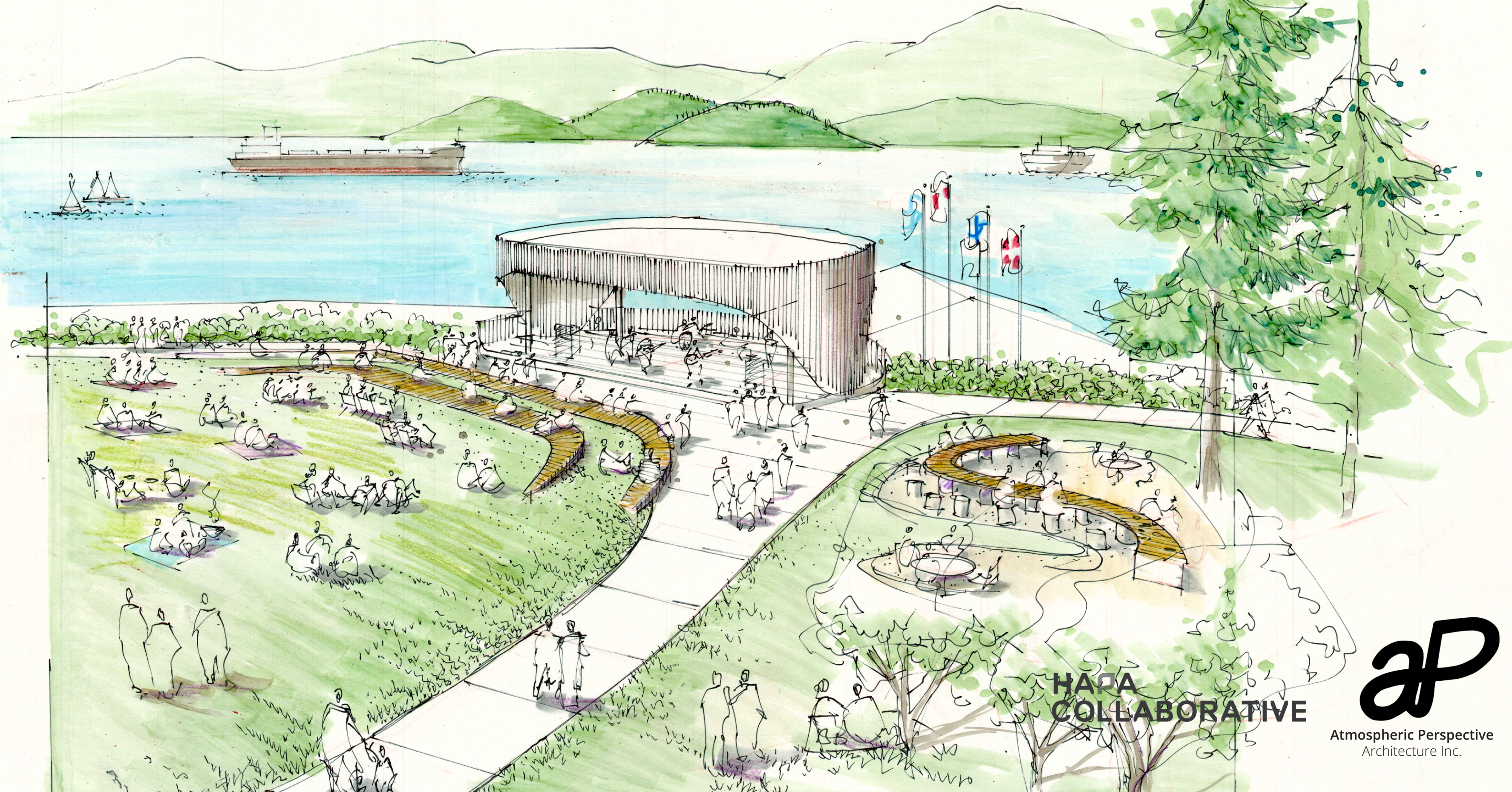

**HAHA
COLLABORATIVE**



Atmospheric Perspective
Architecture Inc.